

**Automatic Air Valves (Double Ball)  
Class PN16**

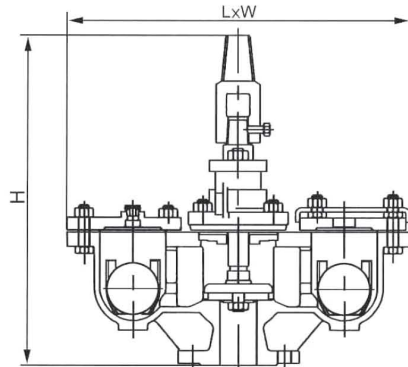
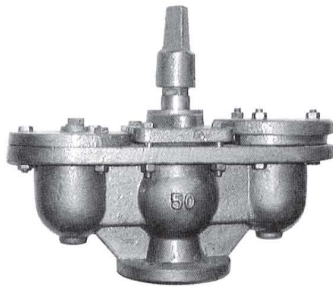

**Components**

1	Body	Cast iron to BS1452 or S. G. cast iron to BS2789
2	Cover	Cast iron to BS1452 or S. G. cast iron to BS2789
3	Stuffing Box	Cast iron to BS1452 or S. G. cast iron to BS2789
4	Gland	Cast iron to BS1452 or S. G. cast iron to BS2789
5	Spindle	Bronze to BS2872 or Stainless steel to BS970
6	Spindle Nut	Bronze to BS2872
7	Float Ball	NBR to BS2494

**Application**

- 1 Flanged and face to BS4504, PN16 or DIN, ANSI standard
- 2 For water and neutral liquids
- 3 Coating epoxy powder inside and outside, 200 – 300 um, for potable water

**Test**

	Working Pressure	16 bars
Test Pressure	Shell	24 bars
	Seat	17.6 bars

**Dimensions**

DN	L	W	H	Flange Dia.	No. of Hole	Dia. of Hole	P. C. D.
50	268	184	454	165	4	18	125
80	504	200	454	200	8	18	160
100	555	236	540	220	8	18	180
150	742	285	710	285	8	23	240
200	850	340	800	340	12	23	295

Unit : mm

**Automatic Air Valves (Single Ball)  
Class PN16**

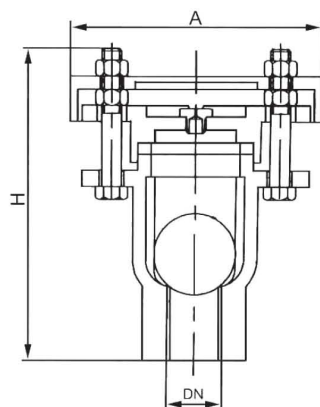

**Dimensions mm**

DN	A	H
13	152	170
25	152	188
50	180	210

**Components**

1	Body	Cast iron to BS1452
2	Bonnet	Cast iron to BS1452
3	Float Ball	NBR to BS2494
4	Gasket	Rubber

**Test**

Working pressure	16 bars
Test Pressure	Shell 24 bars
	Seat 17.6 bars

**Application**

- 1 Male inlet threads according to B. S. P.
- 2 For water and Neutral Liquids
- 3 Coating epoxy powder inside and outside 200 – 300um, for potable water.